

Formica® Hercules Plus™ Locker System

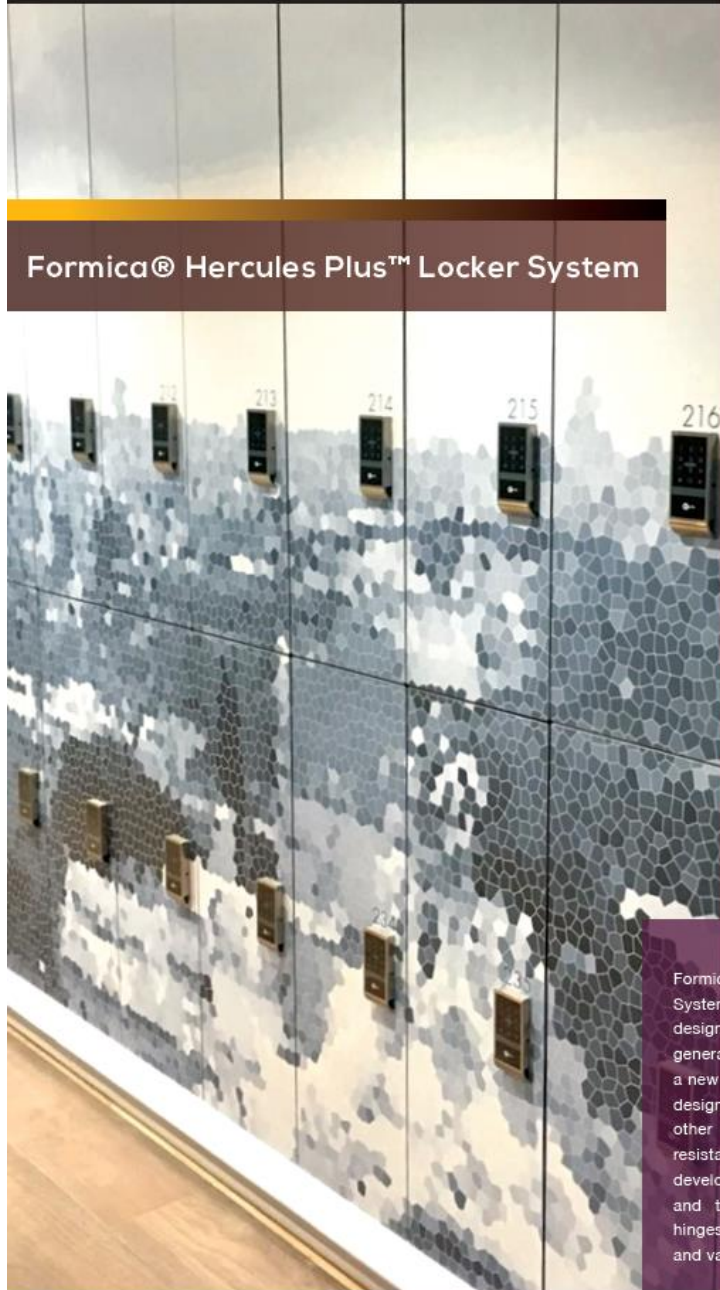

Formica® Hercules Plus™ Locker System is an innovative safety system designed specifically for a new generation of leisure activity. It sets a new standard in the secured locker design. The structural frame and other parts are made of corrosion-resistant aluminium. The newly developed aluminium structural frame and the stainless steel reinforced hinges provide additional strength and vandal proof.



BS EN438

BS478 Part 6 & 7



HK Golf & Tennis Academy



Job Reference

- Hong Kong Polytechnic University
- Lingnan Stadium, CC College, CUHK
- The ISF Academy
- West Island School
- Telebat Center, Hong Kong Jockey Club.
- Hong Kong Electric Building, North Point
- Water Sports Training Centre at Kadoorie Bench
- Diocesan Girl's School

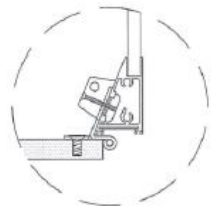
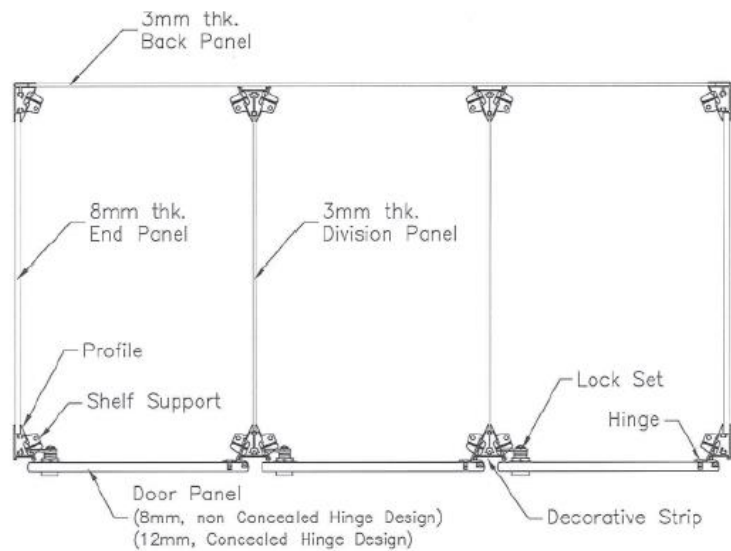

**Standard Design
Non Concealed Hinge**

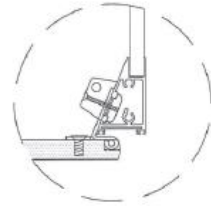

**Optional Design
Concealed Hinge**



City of Dream BOH



HK International School



TSW Sport Centre & Community Hall



Specification

Material:

Formica® Protec+™ Silver (Ag+) antimicrobial compact laminate, blackcore, decopaper on double sides in matte finish or naturelle (NT) finish 12mm thick.

International Standard & Certifications:

Greenguard Gold Certification; Greenguard Certification; BS EN-438-2016; ISO9001; ISO14001; Carbon Reduction Label; BS476 Part 6 and 7; Antifungal ASTM G21:2013 test report, with 0 (None); Antibacterial JIS Z2801:2012 prevent growth of bacterial up to 99.9% within 24 hours.

Hardware:

Continuous anodize aluminium structural profile with full height U shaped channels for insertion of dividing & end panels, and with full height decorative trough on front which may be inserted with Formica® high pressure laminate. Built-in plastic door silencer for absorbing impact & noise when door closing. Stainless steel self-closing hinge, plastic number plate, different types of lock systems available.

Recommended Dimension:

Dimension is highly flexible to suit your requirement.
Standard Dimension: 300mm (W) x 450mm (D) x 1800mm (H) per column

Configuration:

1 – 6 tiers and Z shaped 2 tier per column as request

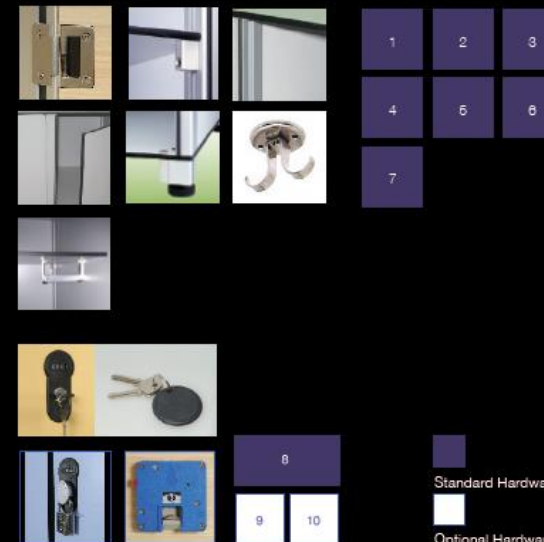

Locker Standard Hardware

- 1) Stainless Steel Locker Hinge
- 2) Shelf Support
- 3) Aluminium End Profile
- 4) Aluminium Centre Profile with Plastic Strip
- 5) Height Adjustable Leg, 50 mm (H)
- 6) Coat Hook
- 7) Hanger Rail

Optional Lock Type

- 8) Standard Number Plate and Cam Lock
- 9) Padlock Device
- 10) Coin Return Lock

Standard Hardware
Optional Hardware